

# 3-Piece Patio Bistro Set Owner's Manual

**MODEL:**

PC32TA1

PC32GY1

PC32BU1



# EAST OAK

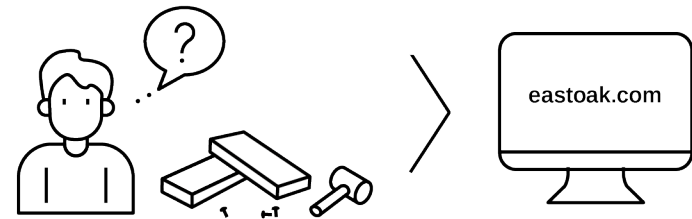

**Questions? Comments?**  
**Reach out to us for expert support!**

✉ [support@east oak.com](mailto:support@east oak.com)

🌐 [east oak.com](http://east oak.com)

📞 1-833-EAST-OAK (USA)

(1-833-327-8625) Mon-Fri 8am-8pm EST

Follow **east oakliving** on



**Claim your 3-year warranty**  
at [east oak.com/warranty](http://east oak.com/warranty)

**Please scan the QR code**  
**to view the installation video**



## IMPORTANT INFORMATION

Please check all parts and components to ensure no damage or missing items before starting the product's construction. If you have any problems or discover any missing parts, please contact customer service at [support@eastoak.com](mailto:support@eastoak.com).

- Some parts may contain sharp edges. Wear protective gloves if necessary during assembly.
- When using power tools, please adjust the gear to the minimum. Otherwise, it will cause damage to the parts.
- Assemble on a soft surface such as a drop sheet or rug to avoid scratching.

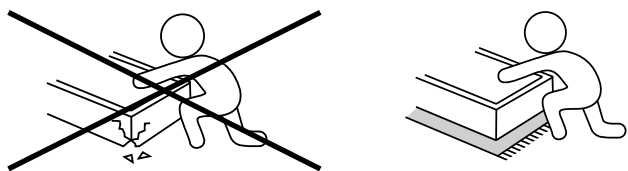

## NOTICE

- Tighten all bolts and screws again within the first two weeks of assembly.
- Check the tightness of all bolts every two months, tighten them if necessary.

## CARE & CLEANING

- For best results, clean the frame with a damp cloth and dry thoroughly. This will help prevent mildew by removing dirt particles that may accumulate.
- Do not clean with abrasive materials, bleach, or solvents.
- Store the set in a dry, sheltered place when not in use.

- Keep the set out of the fire, extreme heat, freezing conditions, and inclement weather such as rain, hail, snow, or wind.
- PLEASE NOTE that the metal paint may come off due to weather conditions.
- Stains on the fabric can be cleaned with lukewarm water with neutral liquid soap, and brushed gently. After washing the stains, air dry without twisting to avoid fabric deformation, and do not use high temperature ironing, so as to avoid high temperature discoloration.



## READ & SAVE BELOW INSTRUCTIONS BEFORE ASSEMBLY

1. Please separate and identify all parts, making sure that you have all of the parts listed.
2. To avoid any scratch during assembly, please assemble on a soft mat or similar.
3. Please assemble step by step and follow the instructions.
4. Washers must be used.
5. While each screw and nut is properly fastened, do not over fasten it.
6. Do not completely fasten each screw and nut until all the screws are properly fixed.

## ASSEMBLY SUGGESTIONS

- Two adults required for a safe assembly



## PARTS LIST



Single Sofa Seat

**A** X 2 PCS

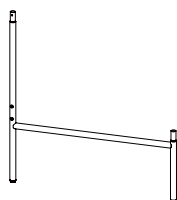

Left Seater Leg

**C** X 2 PCS

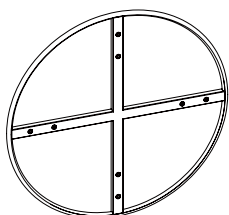
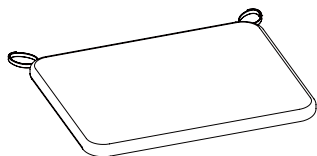

Table Top

**E** X 1 PC



Single-Sofa Seat Cushion

**G** X 2 PCS

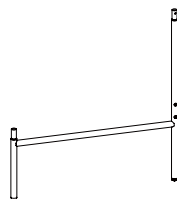

Right Seater Leg

**B** X 2 PCS



Single Sofa Support Pole

**D** X 2 PC

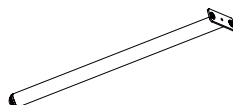

Table Leg

**F** X 4 PCS



M6\*15 Screw

**H** X 24 PCS+ Spare X 1



Washer

**I** X 24 PCS+ Spare X 1



Plastic cap

**J** X 16 PC+ Spare X 1



Hex Wrench

**K** X 1 PC

## WHAT'S IN THE BOX

- 2 x Single Sofa Chairs
- 1 x Coffee Table
- 2 x Single Sofa Seat Cushions
- 1 x Accessory Kit
- 1 x Owner's Manual

# 1 Single-Sofa Chair Assembly

Install right seater leg and seat.



**TIPS:** Keeping the other screws loose until all screws are in place.



**H** X 2PCS



**I** X 2PCS

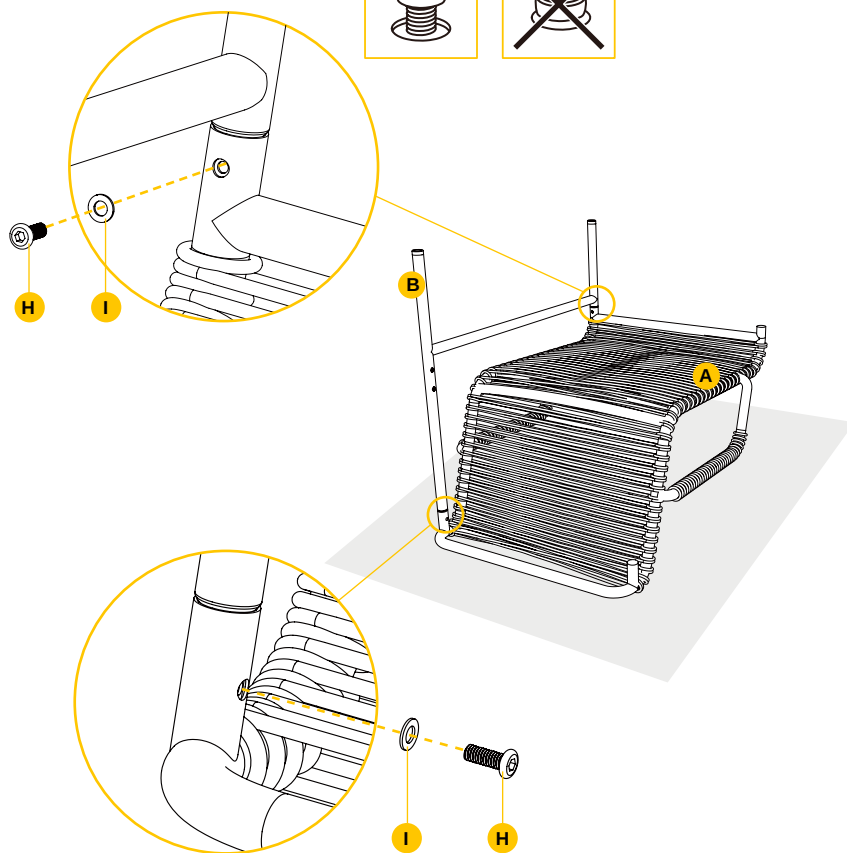

# 2 Install right seater leg and rear link.



**H** X 2PCS



**I** X 2PCS

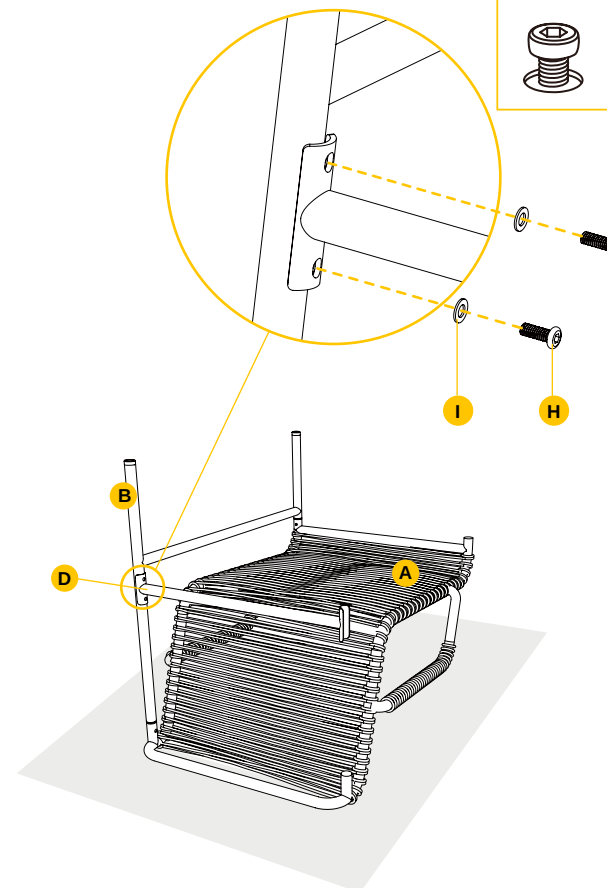

### 3 Install left seater leg and rear link.

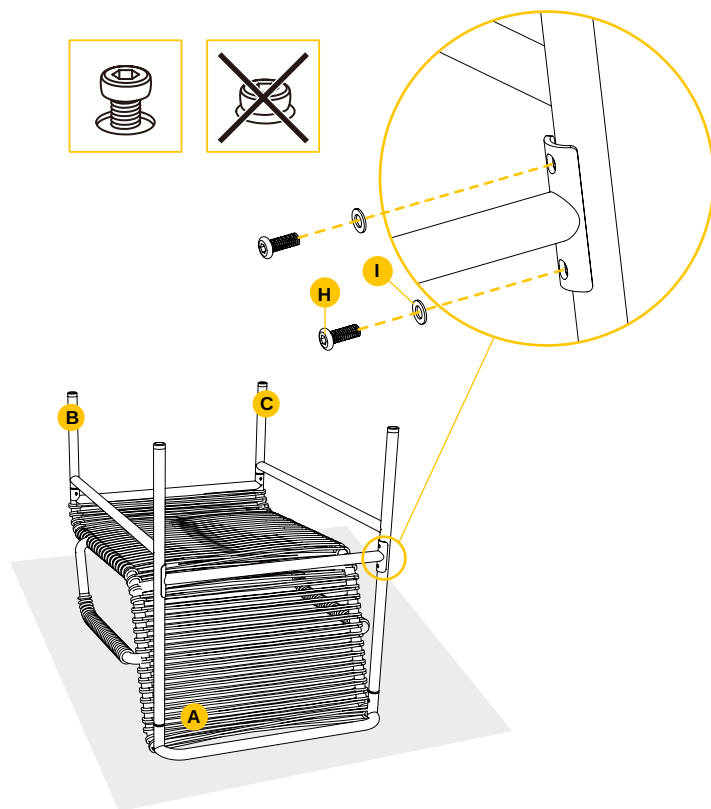

### 4 Install left seater leg and seat.

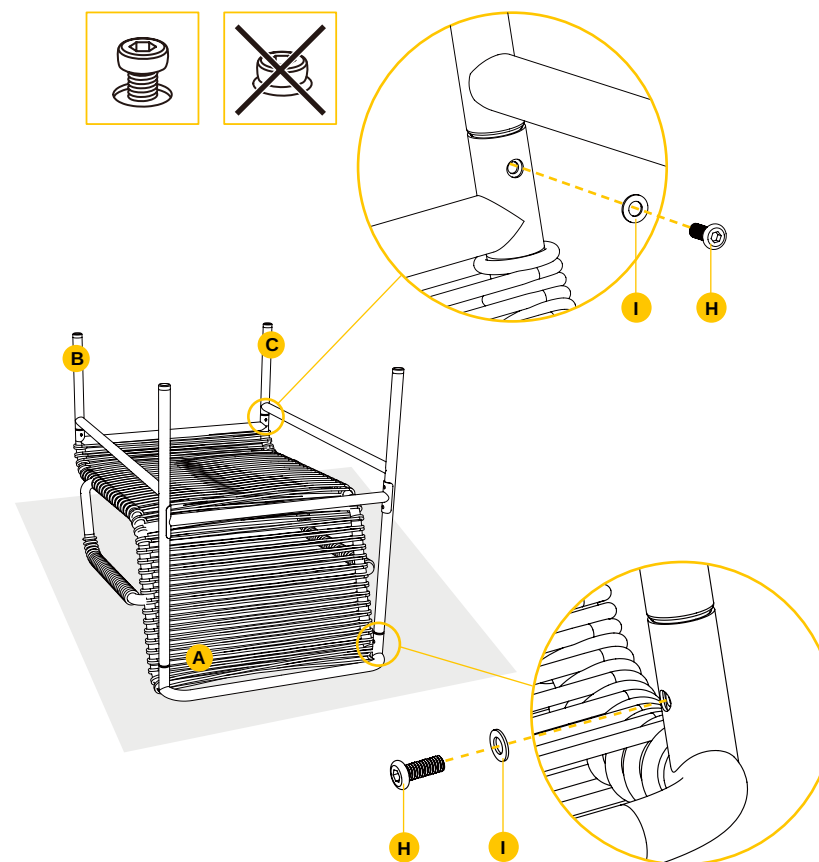

## 5 Straighten the sofa, tighten all the screws, and secure each screw with a plastic cap.



**TIPS:** Keep remaining screws loose until all are in place, then tighten. Secure each with a plastic cap.



**J** X 16PCS

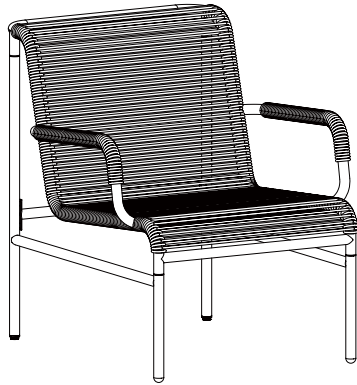

x2



## 6 Put the seat cushion on and fasten it.

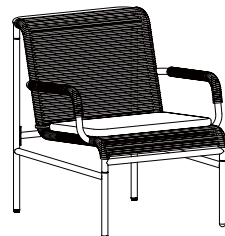
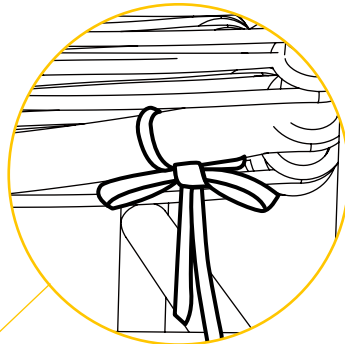
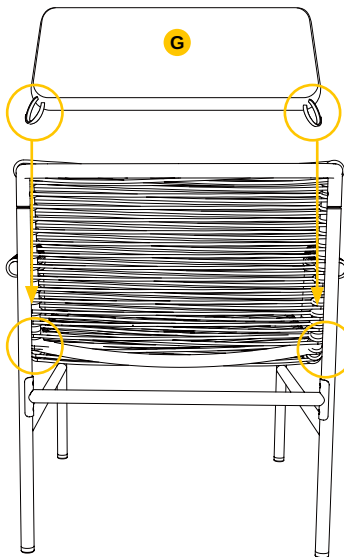

x2

## 7 Coffee Table Assembly

Align the screw holes on the large table top with those on the table legs, and then tighten them with hex wrench.



**TIPS:** Tighten all the screws.



**H** X 8PCS



**I** X 8PCS

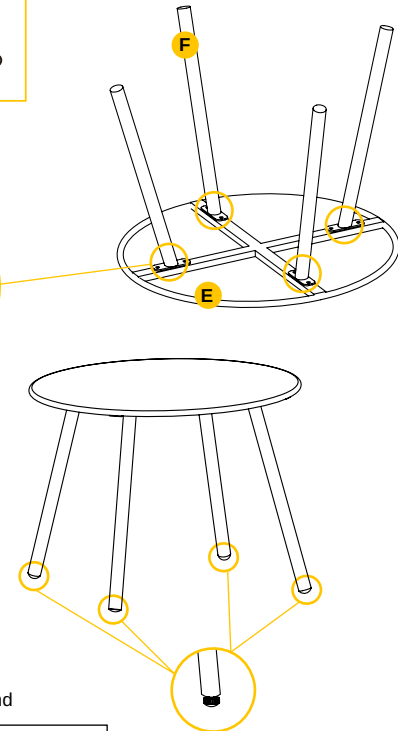
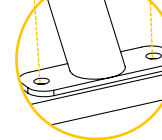
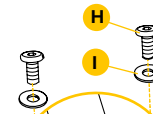

How to keep stable on uneven ground

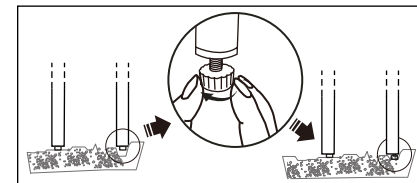

---

## FEATURES

- This 3-piece bistro set exhibits exceptional tensile strength and impressive elasticity, contributing to a comfortable experience.
- The covers of cushions can be removed for easy cleaning and maintenance.
- Utilizing a sturdy metal frame and durable PE rattan, this conversation set is designed to withstand inclement weather conditions.
- The coffee table can be used to place small decor, snacks, or beverages.

---

## TECHNICAL SPECS

- Construction Materials: Steel Frame, Upright Cotton, PE Rattan.
- Weight Capacity:
  - Single Sofa Chair: 330 lbs.
- Assembly Time: 20-30 minutes.
- Product Size:
  - Single Sofa Chair: 26.8 x 31.1 x 31.1 inches.
  - Coffee Table: 41.7 x 16.7 inches.

---

## WARRANTY POLICY

### GUARANTEED 3-YEAR WARRANTY

Thank you for choosing East Oak. This product is covered by our company warranty for up to 3 years from its original purchase date.

### CLAIM WARRANTY

If you'd like to claim your product's warranty, register your new product on our website at [www.eastoak.com/warranty](http://www.eastoak.com/warranty).

---

## WARNING

Cancer and reproductive Harm  
[www.P65Warnings.ca.gov](http://www.P65Warnings.ca.gov).



# EAST OAK

✉ [support@eastoak.com](mailto:support@eastoak.com)

🌐 [eastoak.com](http://eastoak.com)

☎ 1-833-EAST-OAK (USA)