

4-Piece Patio Conversation Set Owner's Manual

MODEL:

AX44TA1

AX44GY1

AX44WH1

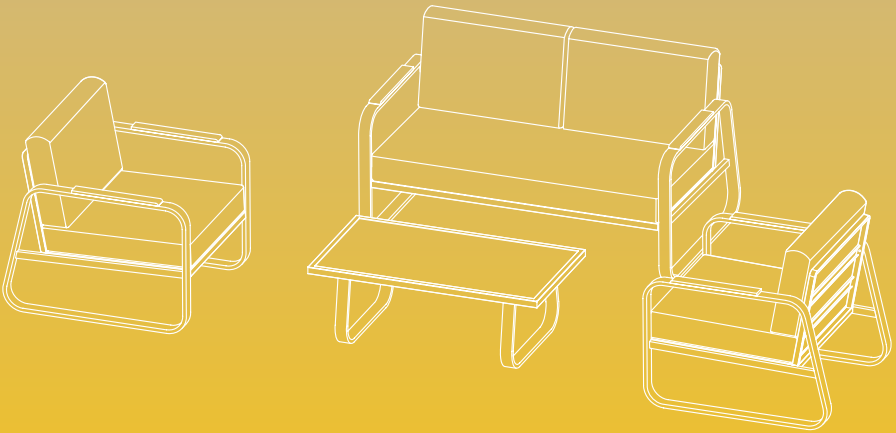

EAST OAK

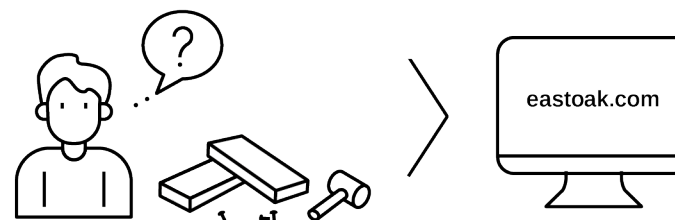

Questions? Comments?
Reach out to us for expert support!

✉ support@eastoak.com

🌐 eastoak.com

☎ 1-833-EAST-OAK (USA)

(1-833-327-8625) Mon-Fri 8am-8pm EST

Follow **eastoakliving** on



Claim your 3-year warranty
at eastoak.com/warranty

Please scan the QR code
to view the installation video



IMPORTANT INFORMATION

Please check all parts and components to ensure no damage or missing items before starting the product's construction. If you have any problems or discover any missing parts, please contact customer service at support@eastoak.com.

- Some parts may contain sharp edges. Wear protective gloves if necessary during assembly.
- When using power tools, please adjust the gear to the minimum. Otherwise, it will cause damage to the parts.
- Assemble on a soft surface such as a drop sheet or rug to avoid scratching.

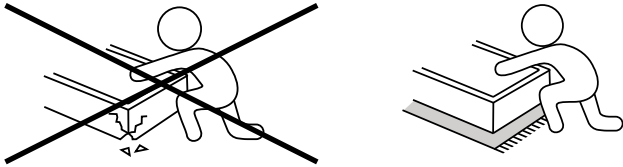

NOTICE

- Tighten all bolts and screws again within the first two weeks of assembly.
- Check the tightness of all bolts every two months, tighten them if necessary.

CARE & CLEANING

- For best results, clean the frame with a damp cloth and dry thoroughly. This will help prevent mildew by removing dirt particles that may accumulate.
- Do not clean with abrasive materials, bleach, or solvents.
- Store the set in a dry, sheltered place when not in use.

- Keep the set out of the fire, extreme heat, freezing conditions, and inclement weather such as rain, hail, snow, or wind.
- PLEASE NOTE that the metal paint may come off due to weather conditions.
- Stains on the fabric can be cleaned with lukewarm water with neutral liquid soap, and brushed gently. After washing the stains, air dry without twisting to avoid fabric deformation, and do not use high temperature ironing, so as to avoid high temperature discoloration.



READ & SAVE BELOW INSTRUCTIONS BEFORE ASSEMBLY

1. Please separate and identify all parts, making sure that you have all of the parts listed.
2. To avoid any scratch during assembly, please assemble on a soft mat or similar.
3. Please assemble step by step and follow the instructions.
4. Washers must be used.
5. While each screw and nut is properly fastened, do not over fasten it.
6. Do not completely fasten each screw and nut until all the screws are properly fixed.

ASSEMBLY SUGGESTIONS

- Two adults required for a safe assembly



PARTS LIST

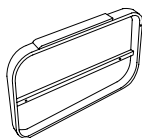

Right Armrest

A X 3 PCS

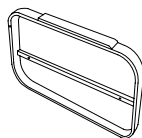

Left Armrest

B X 3 PCS

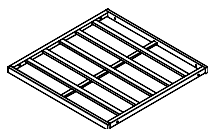

Single-Sofa Plate

C X 2 PCS

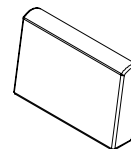

Back Cushion

M X 4 PCS

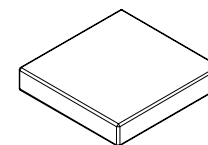

Single-Sofa Seat Cushion

N X 2 PCS

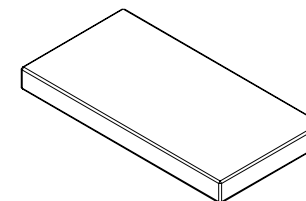

Loveseat Seat Cushion

O X 1 PC

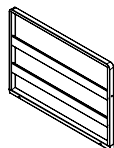

Single-Sofa Backrest

D X 2 PCS

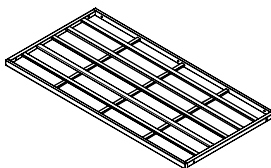

Loveseat Seat Plate

E X 1 PC

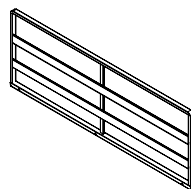

Loveseat Backrest Plate

F X 1 PC

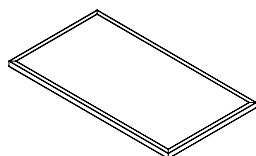

Coffee Table Surface

G X 1 PC

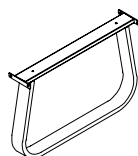

Coffee Table Leg

H X 2 PCS



M6*15 Screw

I X 8 PCS+ Spare X 1

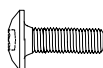

M6*25 Screw

J X 25 PCS+ Spare X 1



Washer

K X 33 PCS+ Spare X 2



Hex Wrench

L X 1 PC

WHAT'S IN THE BOX

- 1 x Loveseat
- 2 x Single Sofas
- 1 x Loveseat Seat Cushion
- 2 x Single Sofa Seat Cushions
- 4 x Back Cushions
- 1 x Coffee Table
- 1 x Accessory Kit
- 1 x Owner's Manual

1 Loveseat Assembly

NOTE: For safety concerns, this step requires two people to assemble.

1.1 First, connect the loveseat backrest plate (F) to the loveseat seat Plate (E) using screws (J) .



TIPS: Keeping the other screws loose until all screws are in place.

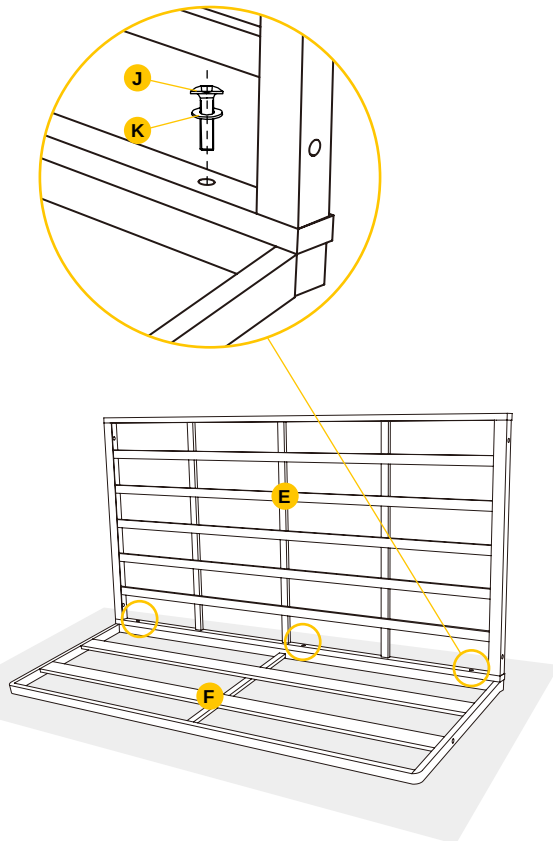
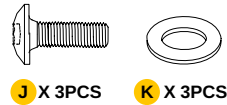

1.2 After installing the loveseat seat and backrest, turn them upside down onto the four sofa cushions, then proceed to install the right and left armrests in turn.

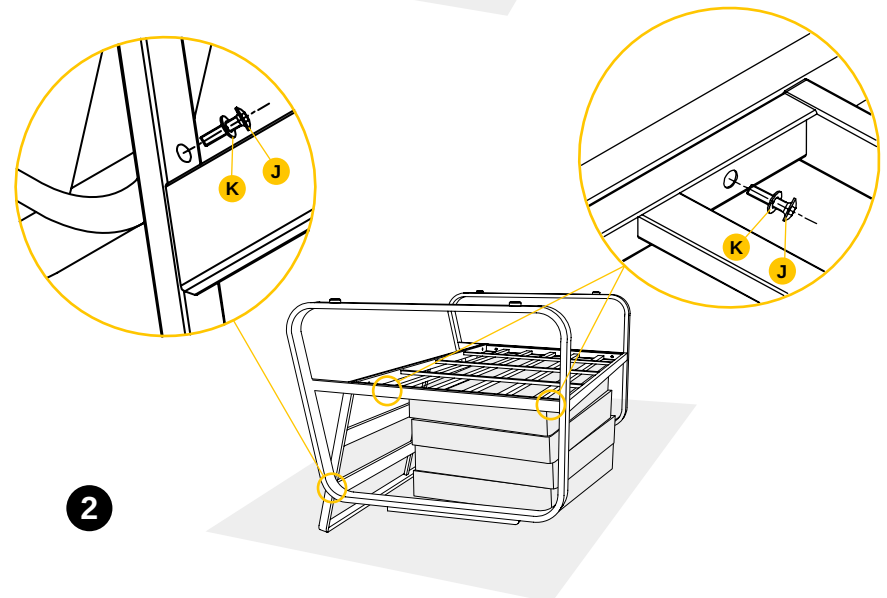
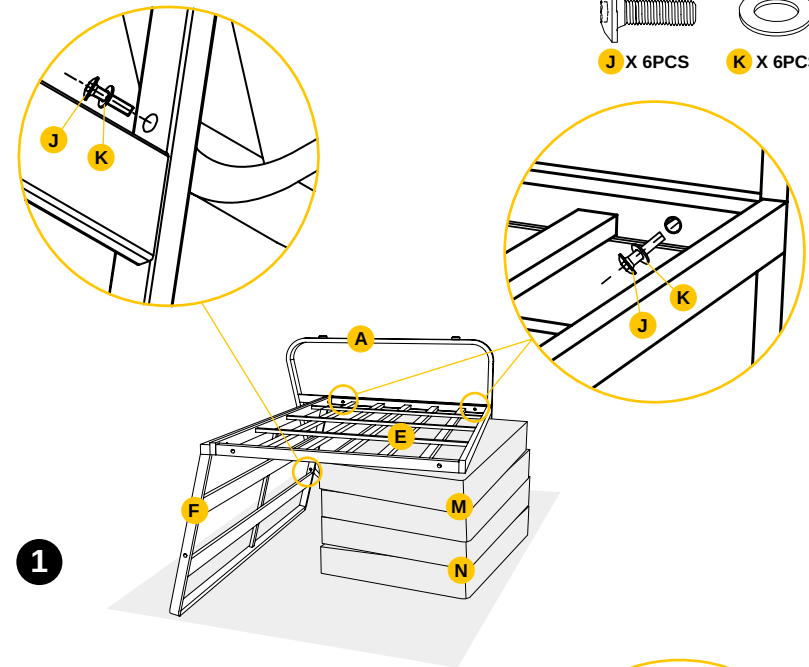
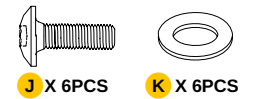

2 Single-Sofa Assembly

2.1 First, connect the single sofa backrest plate (D) to the single sofa plate (C) using screws (J) .

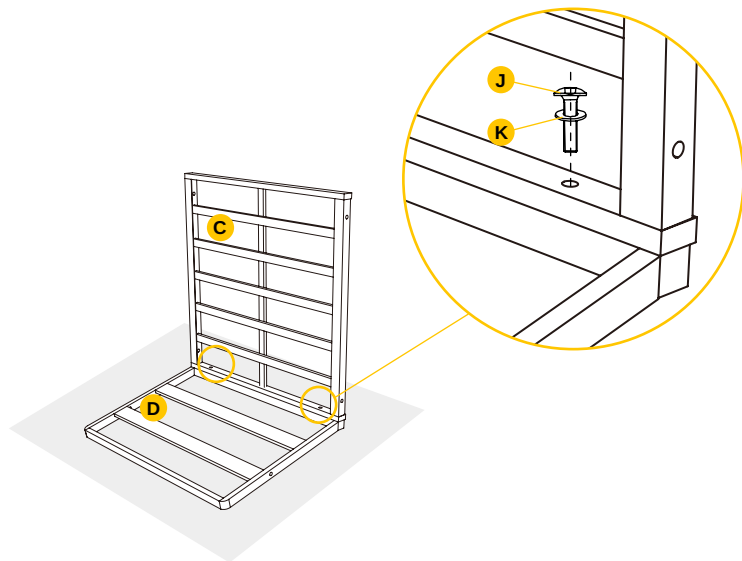
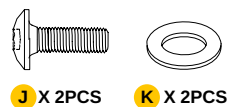

2.2 After installing the single seat and backrest, turn them upside down onto the four sofa cushions, then proceed to install the right and left armrests in turn.

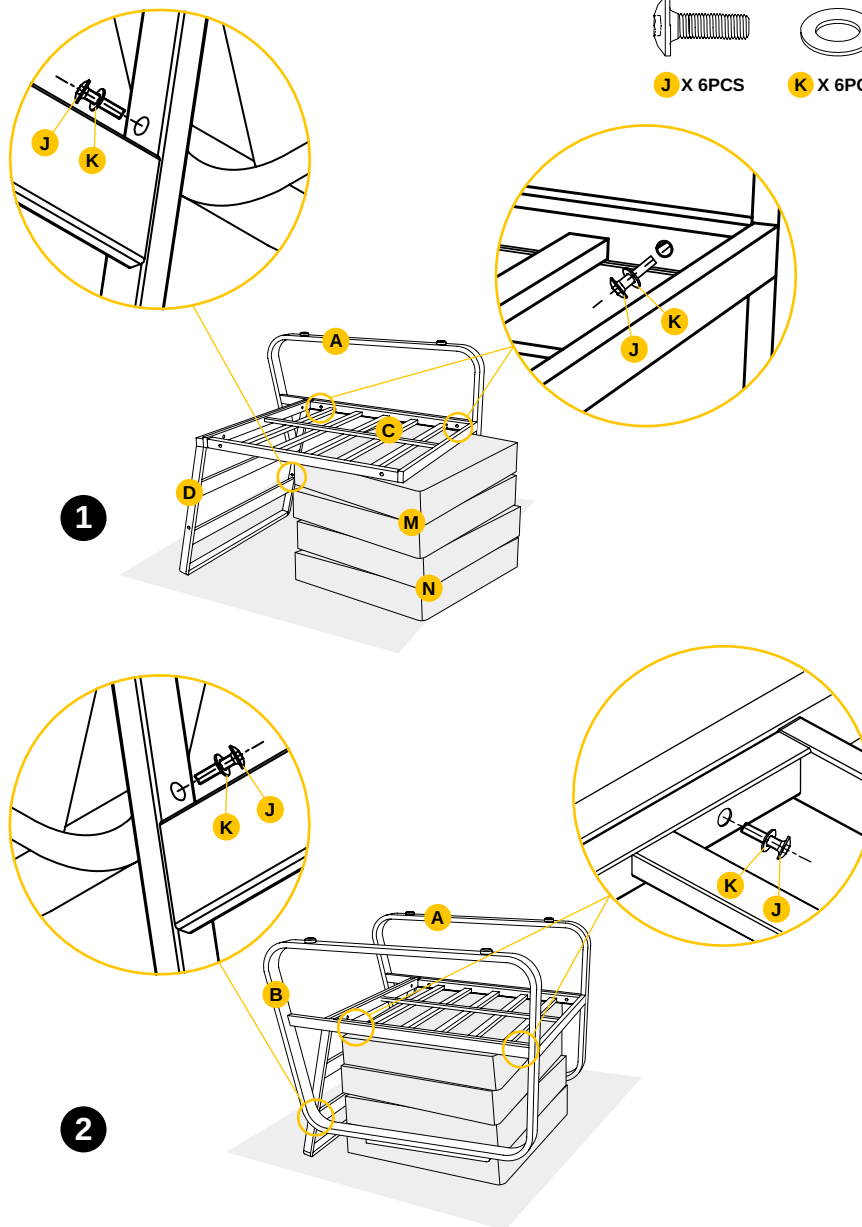
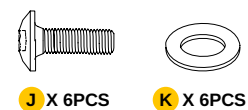

3 Coffee Table Assembly

Place the Coffee Table (G) upside down on a soft, flat surface and attach the Coffee Table Legs (H) to the Coffee Table (G) with the screws (I).

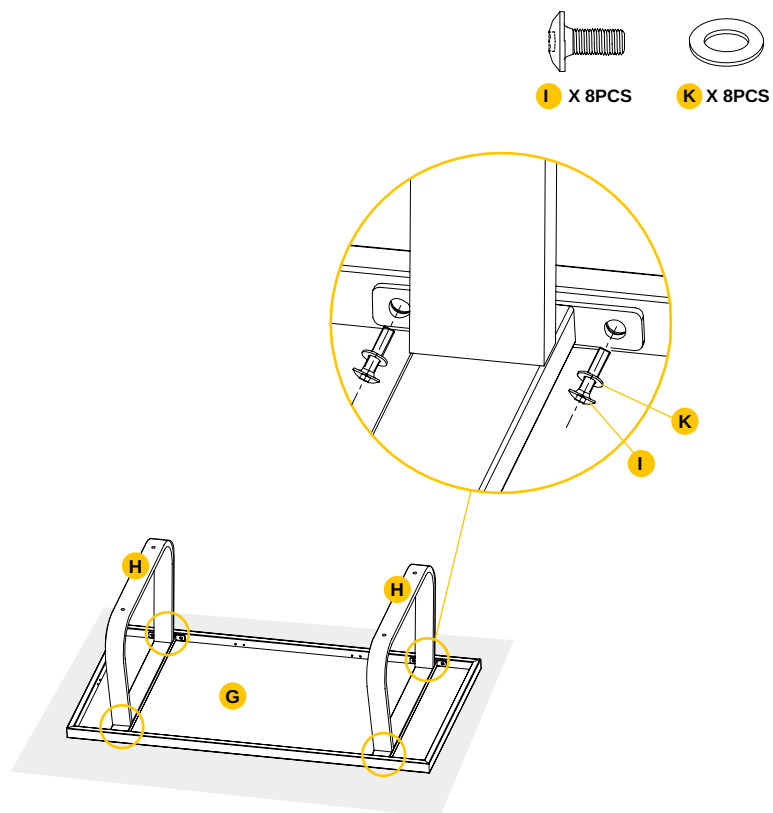

4 Place Seat and Back Cushions

Place the Single Sofa Seat Cushion (N), Loveseat Seat Cushion (O), and Back Cushion (M). Use Velcro to fix the Single Sofa Seat Cushion (N) and Loveseat Seat Cushion (O) respectively onto the Single-Sofa and Loveseat.

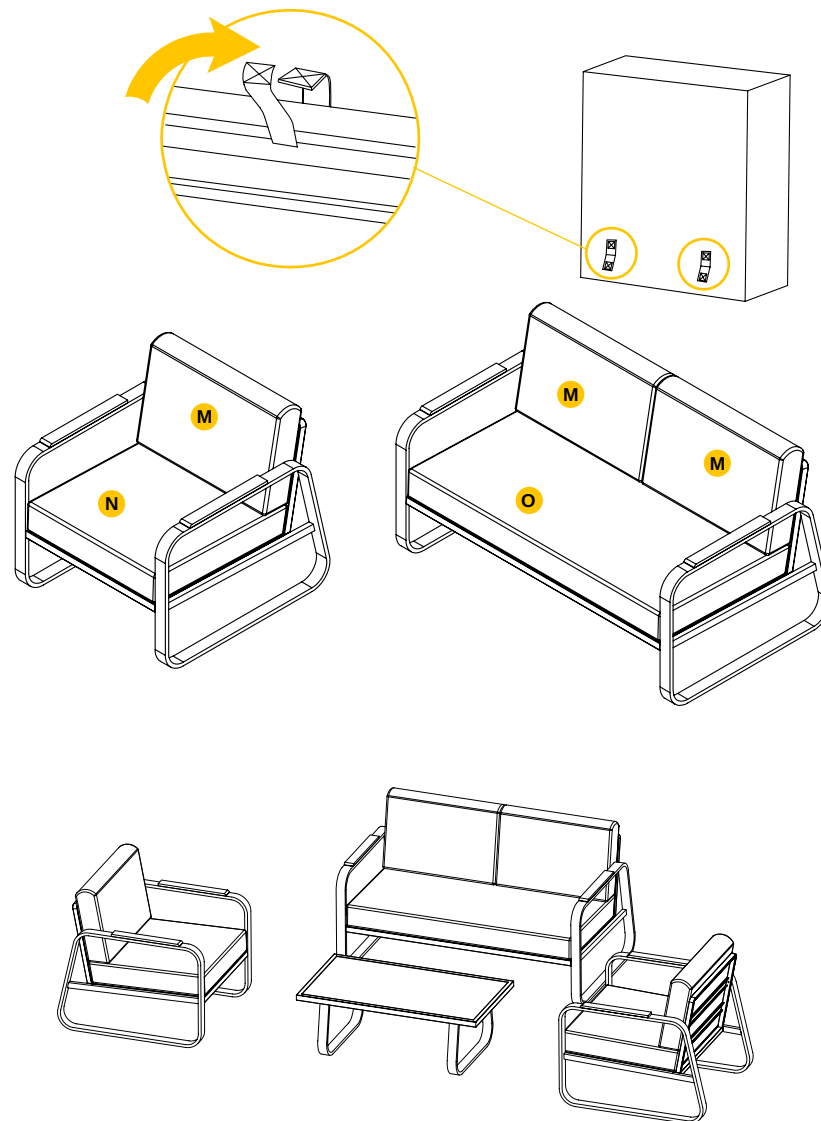

FEATURES

- The 4-piece patio conversation set helps provide a comfortable experience. Soft sponge-filled seats give you extra comfort.
- The covers of cushions can be removed for easy cleaning and maintenance.
- Featuring sturdy treated coated metal frame and TPU-Olefin fabric seat cover, effortlessly tackling outdoor challenges.
- The coffee table can be used to place small decor, snacks, or beverages.

TECHNICAL SPECS

- Construction Materials: Treated Coated Metal Frame, Sponge Cushion.
- Weight Capacity:
 - Loveseat: 660 lbs.
 - Single-Sofa: 330 lbs.
- Assembly Time: 20-30 minutes.
- Product Size:
 - Loveseat: 53.7 x 31.5 x 31.9 inches.
 - Single-Seater Chair: 28.7 x 31.5 x 31.9 inches.
 - Coffee Table: 35.4 x 17.7 x 14 inches.

WARRANTY POLICY

GUARANTEED 3-YEAR WARRANTY

Thank you for choosing East Oak. This product is covered by our company warranty for up to 3 years from its original purchase date.

CLAIM WARRANTY

If you'd like to claim your product's warranty, register your new product on our website at www.eastoak.com/warranty.

WARNING

Cancer and reproductive Harm
www.P65Warnings.ca.gov.

EAST OAK

✉ support@eastoak.com

🌐 eastoak.com

☎ 1-833-EAST-OAK (USA)